



**49<sup>th</sup> Annual**  
**Pacific Northwest Regional Economic Conference**

Challenges and Opportunities in the Pacific Northwest

Best Western Plus Lakeway Inn  
**Bellingham, Washington**

Wednesday April 22, Thursday April 23rd and Friday April 24th, 2015

**PACIFIC NORTHWEST REGIONAL ECONOMIC CONFERENCE 2015**

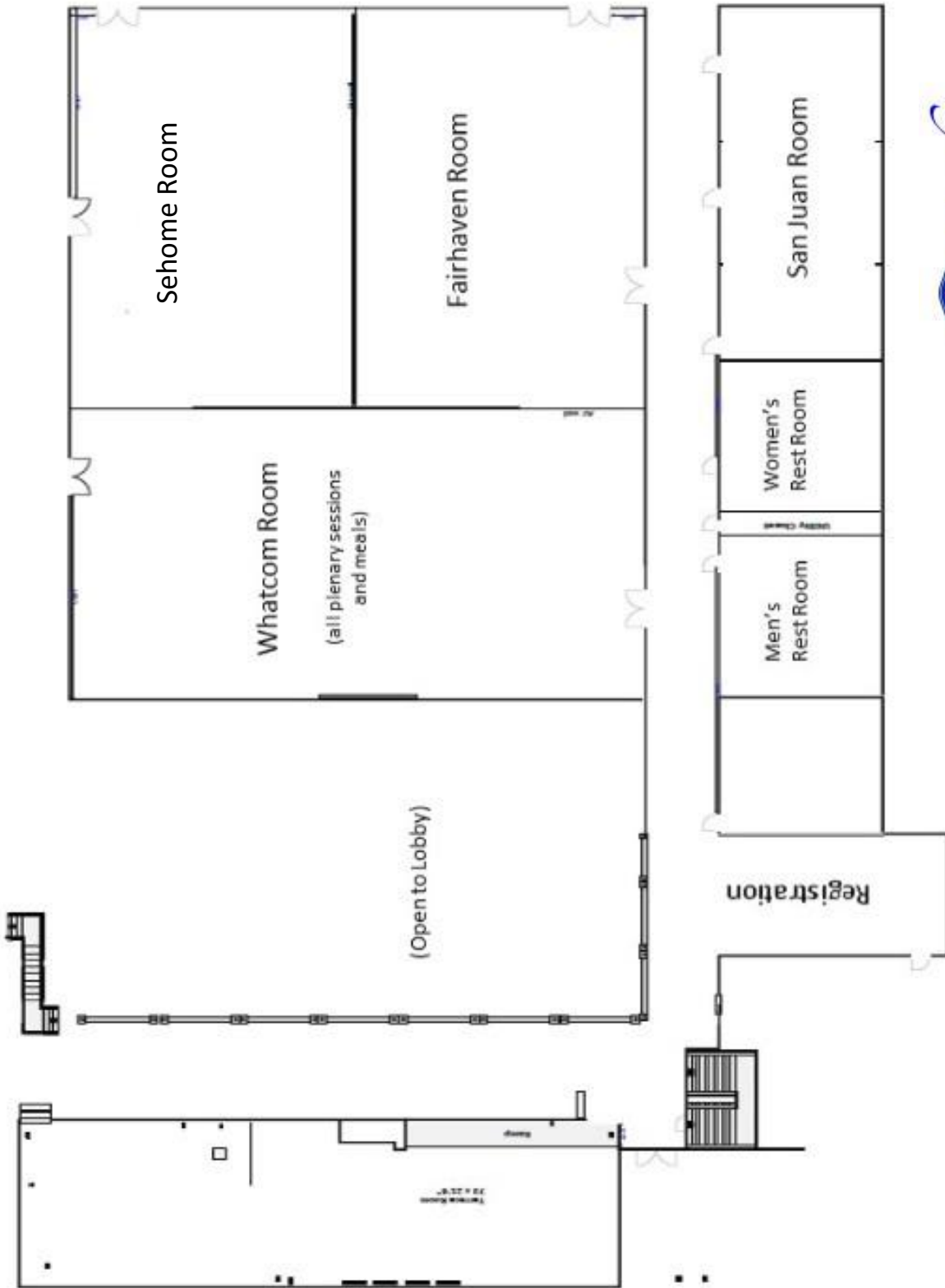

**PACIFIC NORTHWEST REGIONAL ECONOMIC CONFERENCE 2015**



49th Annual  
Pacific Northwest Regional Economic Conference  
Challenges and Opportunities in the Pacific Northwest

## GENERAL INFORMATION

Name Tag: This is your admission ticket to all conference sessions, social events, coffee breaks and food. Please wear it at all times.

Electronic Devices: In consideration of speakers and other delegates, please silence your beepers and ringers.

CPE Credit: Western Washington University's College of Business and Economics is able to issue CPE documentation under the definitions of the Washington State Board of Accountancy for many of the sessions offered at the conference. If you would like CPE credit for any portion of the conference please stop by the registration desk for more information.

Need Assistance? The conference host would love to help you. Stop by the registration table anytime to ask questions or talk with Hart Hodges or James McCafferty.

49th Annual  
Pacific Northwest Regional Economic Conference  
Challenges and Opportunities in the Pacific Northwest

**CONCURRENT SESSIONS**

<u>Session</u>	<u>Title</u>	<u>Room</u>
<b><u>Thursday 9:45-11:00</u></b>		
1	US Census Staff: On the Map	Fairhaven
2	Student Research	San Juan
3	Slowing Growth of Real GDP	Sehome
<b><u>Thursday 11:05-12:20</u></b>		
4	US Census Staff: Job-to-Job	Fairhaven
5	Carbon Pricing and Climate Change	Sehome
6	Real Estate Financing	San Juan
<b><u>Thursday 2:15-3:30</u></b>		
7	Economic and Fiscal Impact Analysis	Fairhaven
8	Increasing Efficiency of Border Crossing Infrastructure	Sehome
9	Dimensions of Wage and Income Inequality Across the Pacific NW	San Juan
<b><u>Friday 9:30-11:00</u></b>		
10	Labor Markets	Fairhaven
11	Water Resources	Sehome
12	Economics and Agriculture	San Juan
<b><u>Friday 11:10-12:25</u></b>		
13	Transportation	San Juan
14	Fossil Fuels	Sehome
15	Social Policy and Issues	Fairhaven
<b><u>Friday 2:10-3:20</u></b>		
16	Economics of Higher Ed	Fairhaven
17	Energy and Climate	Sehome
<b><u>Friday 3:30-5:00</u></b>		
	State and Provincial Forecasts	Whatcom



49th Annual  
Pacific Northwest Regional Economic Conference  
Challenges and Opportunities in the Pacific Northwest

**Challenges and Opportunities in the Pacific Northwest**

**WEDNESDAY APRIL 22, 2015**

5:00 pm Registration Opens  
*Second Floor Foyer*

5:00 pm - 7:00 pm Welcome reception (Appetizers and a drink ticket. No Host Bar)  
*First Floor Lobby*

**THURSDAY APRIL 23, 2015**

7:00 am - 5:00 pm Registration  
*Second Floor Foyer*

8:00 am - 8:30 am **BUFFET BREAKFAST**  
*Whatcom Room*

8:30 am - 9:30 am **Conference Open**  
Hart Hodges, Director, Center for Economic and Business  
Research, Western Washington University

**National Outlook**  
Duncan Meldrum, Hilltop Economics

## **9:45 AM-11:00 AM CONCURRENT SESSIONS**

### **Session 1: US Census Staff: “On the Map”**

**Chair: Scott Bailey, Washington State Employment Security Department**  
*Fairhaven Room*

### **Session 2: Student Research**

**Chair: Brandon Dupont, Western Washington University**  
*San Juan Room*

Glenn Handley, Western Washington University, Effects Of Student Debt On Home Ownership

Jesse M. Thurman, Oregon State University, A Cost-Benefit Analysis of Underage Drinking from a Minimum Legal Drinking Age Perspective: An Economic Approach

To Be Announced

### **Session 3: Panel on Causes and Consequences of Slowing Real GDP Growth**

**Chair: Paul Storer, Western Washington University**  
*Sehome Room*

Calista Cheung, Vancouver Regional Office, Bank of Canada.

Duncan Meldrum, Hilltop Economics LLC,

Fanny Roberts, Washington State Office of Financial Management.

**11:05 AM-12:20 PM CONCURRENT SESSIONS**

**Session 4: US Census Staff: “Job-to-Job”**

**Chair: Scott Bailey, Washington State Employment Security Department**  
*Fairhaven Room*

**Session 5: Carbon Pricing and Climate Change**

**Chair: Yoram Bauman, University of Washington**  
*Sehome Room*

Jeff Renfro, Portland State University, Carbon Pricing in Oregon

Greg Nothstein, Washington State Department of Commerce, Washington  
Carbon Tax Assessment Model

Fanny Roberts and Toby Paterson, Washington State Office of Financial  
Management, Economic impact of emissions reductions in the state of  
Washington.

**Session 6: Real Estate Financing**

**Chair: Chris Lawless, BC Investment Management Corporation**  
*San Juan Room*

Mike Wilson, CEO, Seattle Federal Home Loan Bank

Tsur Somerville, Sauder School of Business, University of British Columbia.

Chris Lawless, BC Investment Management Corporation

**12:30 pm - 2:00 pm**

**LUNCH**

*Whatcom Room*

**Remarks**

Massoud Jourabchi,  
Northwest Power and Conservation Council

**“Innovation: What if the Rural Phenomenon is Mostly  
Outside Science and Engineering”**

Tim Wojan, Economic Research Service, USDA

## **2:15 PM - 3:30 PM CONCURRENT SESSIONS**

### **Session 7: Economic and Fiscal Impact Analysis**

**Chair: Patrick Balducci, Pacific Northwest National Laboratory**

*Fairhaven Room*

Spencer Cohen, University of Washington, Assessing the Economic and Fiscal Aspects of Washington's Food Systems: An Input-Output Analysis.

Bryan Calkin, Washington State Department of Transportation, Predicting Vehicle and Gasoline Tax Revenues.

Bill Beyers, University of Washington, Sectoral Differences in Labor Required to Support Output: Evidence from Eight Input-Output Models in Washington State

### **Session 8: Increasing Efficiency of Border Crossing Infrastructure**

**Chair: Paul Storer, Western Washington University**

*Sehome Room*

David Davidson, Western Washington University, *Proposed Pilot Project: Using RFID to Reduce Border Queues.*

Mark Springer, Western Washington University, *Speeding up FAST: Shortening Waiting Times for Commercial Freight at the*

*Canada-U.S. Border*

Paul Storer and Steve Globberman, Western Washington University, *An Assessment of Future Bilateral Trade Flows and Their Implications for U.S. Border Infrastructure Investment*

### **Session 9: Dimensions of Wage and Income Inequality Across the Pacific NW**

**Chair: Gary Smith, PNREAP**

*San Juan Room*

Gary W. Smith, Pacific Northwest Regional Economic Analysis Project, Regional Income Inequality Forever? The Saga of Washington State

Anneliese Vance-Sherman, Ph.D., Employment Security Department, Washington State

Gary, Anneliese, et. al., Calibrating Per Capita Income Inequality Across the Pacific Northwest On the Fly and...Wherever Else?





49th Annual  
Pacific Northwest Regional Economic Conference  
Challenges and Opportunities in the Pacific Northwest

- 3:30 pm - 3:45 pm      Networking Break.
- 3:45 pm to 5:15 pm      **What's Wrong with Finance and How to Fix It**  
Ashby Monk, Stanford University  
*Whatcom Room*
- 5:30 pm - 6:00 pm      Reception  
... and talking with students about what to do with an econ degree  
*Second Floor Foyer*
- 6:00 pm -                Local Economic Impact Event  
*See page 13*

**FRIDAY APRIL 24 2015**

- 7:30 am - 12:00 pm      Registration  
*Second Floor Foyer*
- 8:00 am to 8:30 am      **BUFFET BREAKFAST**  
*Whatcom Room*
- Remarks**  
James K. Hill, Consul General of Canada in Seattle
- 8:30 am to 9:20 am      **Sustainability and Fuel Development**  
Peter MacConnachie, Suncor Energy  
*Whatcom Room*
- 9:20 am to 9:30 am      Networking Break

**9:30 AM -11:00 AM CONCURRENT SESSIONS**

**Session 10: Labor Markets**

**Chair: Nick Beleiciks, Oregon Employment Department**

*Fairhaven Room*

Scott Benson, Idaho State University, Are Wages in Idaho Really that Low? Why?

Christian Kaylor, Oregon Employment Department, Metro job growth trends

Scott Bailey, Washington State Dept. of Employment Security, Minimum wage

**Session 11: Water Resources**

**Chair: Jonathan Yoder, Washington State University**

*Sehome Room*

Michael Brady, Washington State University, The Columbia River Treaty Renegotiation from the Perspective of Contract Theory

Levan Elbakidze, University of Idaho, Evaluating a Water Buyback Program

Shane Johnston, University of Washington, Rural Development and Property Tax Impacts of Removing Domestic Permit Exemptions: the Kittitas Experience

Jonathan Yoder, Washington State University, Benefit-Cost Analysis of the Yakima Basin Integrated Plan

**Session 12: Economics and Agriculture**

**Chair: Tom Potiowsky, Portland State University**

*San Juan Room*

Kwangyoung Lee, Washington State University, Effects of Labor shortages on the production, harvesting, marketing, and distribution of horticultural commodities.

Lee Cartier, Okanagan College, The Economic Benefits of Using Sterile Insect Technique and Mating Disruption, Rather Than Pesticides, to Control Codling Moth in Apples and Pears

Logan Blair, Central Washington University, Economic Impacts of Forest Pathogens in Washington State

Matt Chatham, Eastern Oregon University, The Impact of Wolves on Agricultural Land Values in Oregon.

## **11:10 AM -12:25 PM CONCURRENT SESSIONS**

### **Session 13: Transportation**

**Chair: Patrick Balducci, Pacific Northwest National Laboratory**

*San Juan Room*

Terry Wechsler, Environmental Attorney and Fred Felleman, Friends of the Earth

Becky Knudson, Oregon Department of Transportation, Estimated Impacts of Deteriorating Highway Conditions to the Oregon Economy.

Patrick Balducci, Pacific Northwest National Laboratory, Estimating the Economic Impact of Air Cargo Operations at Airports

### **Session 14: Fossil Fuels**

**Chair: Terry Morlan, Northwest Power and Conservation Council**

*Sehome Room*

Toni Sipic, Central Washington University, Oil spills as catalyst for international environmental regulation.

Phillip Watson, University of Idaho, State level petroleum production, consumption and income volatility: Quantifying the winner and losers.

Patrick Barkey, University of Montana

### **Session 15: Social Policy and Issues**

**Chair: James McCafferty, Western Washington University**

*Fairhaven Room*

Ehsan Latif, Thompson Rivers University, Comparison of Income and Happiness: Evidence from Canada

Tania Briceno, Earth Economics, The Economics of Recreation

Tom Potiowsky, Portland State University, Retirement Security in Oregon

12:30 pm - 2:00 pm

### **LUNCH**

*Whatcom Room*

### **Tiebout Lecture**

Jean-Claude Thill, University of North Carolina-Charlotte

## **2:10 PM-3:20PM CONCURRENT SESSIONS**

### **Session 16: Economics of Higher Ed**

**Chair: James McCafferty, Western Washington University**

*Fairhaven Room*

Dave Bunting, Eastern Washington University,

Nathaniel Clayville, Division of Financial Management, State of Idaho,  
Forecasting Support Units for High Education

To Be Announced

### **Session 17: Energy and Climate**

**Chair: Massoud Jourabchi, Pacific Northwest National Laboratory**

*Sehome Room*

Patrick Balducci, Pacific Northwest National Laboratory

Massoud Jourabchi, Northwest Power and Conservation Council, Assessing  
the Economic Benefits of Energy Storage Technologies Funded by the  
Washington Clean Energy Fund

Jean Daniels and Michael Paruszkiewicz, US Forest Service, Estimates of  
Wood Energy Demand for Residential Use in Alaska.

3:30 pm - 5:00 pm

### **PANEL PRESENTATION**

*Whatcom Room*

#### **State and Provincial Forecasts**

Chair: Hart Hodges, Western Washington University  
Ken Peacock – British Columbia, Nathaniel Clayville –  
Idaho, Pat Barkey – Montana, Nick Beleiciks – Oregon,  
Roger Coupal – Wyoming, Steve Lerch – Washington,  
Caroline Schultz – Alaska, invited – Alberta,  
Jamie Coles – Yukon Territory.

5:00 pm

Conference close

5:00 pm - 7:00 pm

Board Meeting  
*Board Room*



## Local Economic Impact Event

Every project needs good research questions and the tools to succeed. Tonight, try your hand at this:

The Pacific Northwest is a national hotspot for micro-brewing. Whatcom County is home to a number of significant award winning – regional, national and international – breweries. Washington has nearly 300 licensed microbreweries in operation. The largest produced more than 900,000 barrels last year. The smallest produced 1. Whatcom County operations brewed nearly 52,000 barrels last year – or 1.6 million gallons.

Your mission, should you choose to accept it, is to visit several of the identified locations to generate economic impacts and to assist these establishments. Of course, you should also check for quality since we all know for sustainable impact those customers need to keep coming back.

If you need guidance please ask a host.

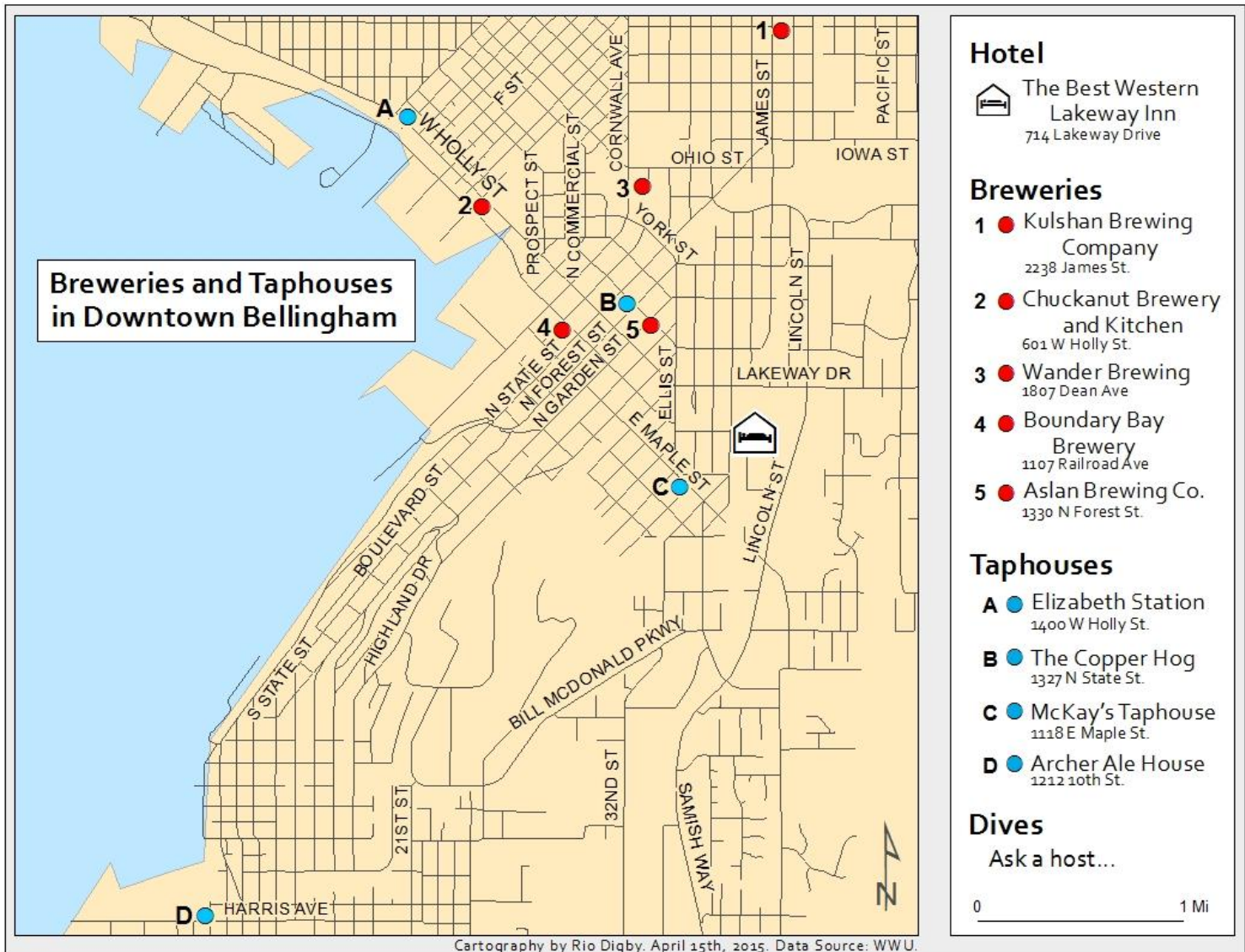

49th Annual  
Pacific Northwest Regional Economic Conference  
Challenges and Opportunities in the Pacific Northwest

**PNREC 2015 CONFERENCE COMMITTEE**

Program Co-Chairs: Hart Hodges and James McCafferty

PNREC Website: Paul Storer

Executive Committee: William B. Beyers, Patrick Balducci, Chris Lawless, Terry Morlan

**PNREC BOARD OF DIRECTORS**

**Dr. William B. Beyers**, PNREC President, Department of Geography, University of Washington

**Mr. Patrick Balducci**, PNREC Vice President and President-Elect, Pacific Northwest National Laboratory

**Mr. Chris Lawless**, PNREC Secretary, Chief Economist, BC Investment Management Corporation

**Dr. Terry Morlan**, PNREC Treasurer, Retired Manager, Economic Analysis, Northwest Power and Conservation Council

**Mr. Scott Bailey**, Washington Employment Security Department

**Dr. Patrick Barkey**, PNREC President, Bureau of Business and Economic Research, University of Montana

**Mr. Nick Beleiciks**, State Employment Economist, Oregon Employment Department

**Dr. C. Scott Benson**, Department of Economics, Idaho State University

**Mr. Nathaniel Clayville**, Idaho Division of Financial Management

**Dr. Roger Coupal**, Department of Agricultural and Applied Economics, University of Wyoming

**Dr. Kelley Cullen**, Economics Department, Eastern Washington University

**Ms. Carol Frketich**, Canada Mortgage and Housing Corporation

**Dr. Hart Hodges**, Center for Economic and Business Research, Western Washington University

**Mr. Massoud Jourabchi**, Northwest Power and Conservation Council

**Dr. Riley Moore**, School of Business, Saint Martins University

**Dr. Tom Potiowsky**, Chair, Department of Economics, Portland State University

**Dr. Gary W. Smith**, Director, Pacific Northwest Regional Economic Analysis Project, Central Washington University

**Dr. Paul Storer**, Economics Department, Western Washington University

**Mr. Jim Sylvester**, Bureau of Business and Economic Research, University of Montana



49th Annual  
Pacific Northwest Regional Economic Conference  
Challenges and Opportunities in the Pacific Northwest

**To all our partners, speakers, paper presenters, chairs and volunteers:**

**Thank You!**

SEE YOU IN MAY  
2016 IN  
VANCOUVER,  
WASHINGTON FOR  
PNREC 2016

## CONFERENCE SUPPORTERS

PNREC 2015 is fortunate to have support from:



Northwest **Power** and  
**Conservation** Council



Consulate General of **Canada** / Seattle  
Consulat Général du **Canada** / Seattle

